

SPECIFICATIONS

DIELECTRIC STRENGTH: AC250V /1MIN
 RATING: DC12V,50mA MAX
 CONTACT RESISTANCE: 100mΩ MAX
 INSULATION RESISTANCE: 100MΩ MIN
 OPERATING LIFE: 200,000 CYCLES
 OPERATING FORCE: 80gf±30gf,120gf±30gf,
 160gf±30gf,250gf±50gf,400gf±100gf

MATERIALS

BASE: LCP, BLACK
 TERMINAL: PHOSPHOR BRONZE, SILVER PLATED
 CONTACT: STAINLESS STEEL, SILVER PLATED
 COVER: STAINLESS STEEL
 ACTUATOR: LCP

ORDER INFORMATION

6 S T M S 0 8 - X X X X X X X X X A 0 1

TABLE \triangle

| P/N | OPERATING FORCE |
|----------------------|-----------------|
| 6STMS08-014080XNXA01 | 80gf±30gf |
| 6STMS08-014160XNXA01 | 160gf±30gf |
| 6STMS08-014250XNXA01 | 250gf±50gf |
| 6STMS08-014400XNXA01 | 400gf±100gf |
| 6STMS08-014120XDXA01 | 120gf±30gf |
| 6STMS08-014160XDXA01 | 160gf±30gf |
| 6STMS08-014250XDXA01 | 250gf±50gf |
| 6STMS08-014400XDXA01 | 400gf±100gf |

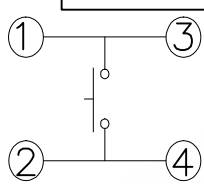
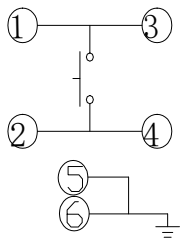
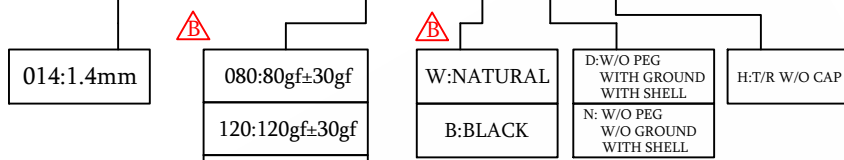

6STMS08-XXXXXXDXA01 6STMS08-XXXXXXNXA01

CIRCUIT DIAGRAM

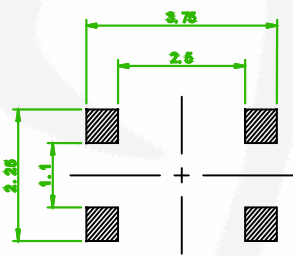
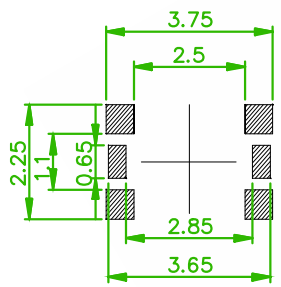
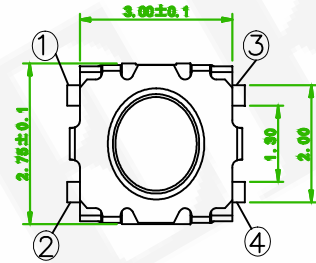
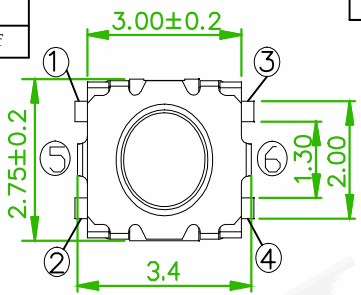

6STMS08-XXXXXXDXA01 6STMS08-XXXXXXNXA01

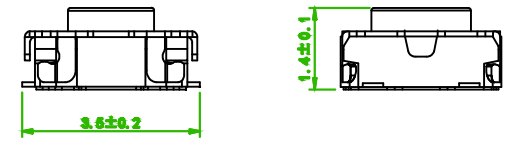
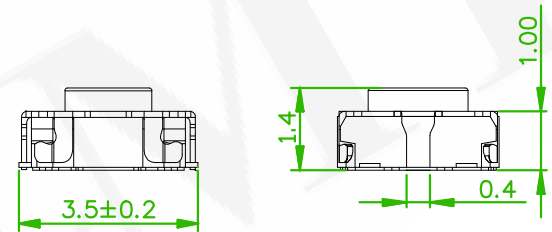

6STMS08-XXXXXXDXA01 6STMS08-XXXXXXNXA01

RECOMMENDED PCB LAYOUT
(PCB TOLERANCE ±0.05)

| | | | |
|-------------|------------------------|---------|------------|
| \triangle | REC2510000093 | Oliver | 2025/10/30 |
| \triangle | REC2507000005 | Gaby | 2025/07/02 |
| \triangle | BPM 20250613001 | John | 2025/06/27 |
| REV. | ECN NO. OR DESCRIPTION | REVISED | DATE |

| | | | | | | |
|----------------------|--------------------------|-------------|------|------------------------------|--------------------|-----|
| 品名 TITLE | TACT SWITCH SMT V/T TYPE | | | | 頁數 Page | 1/1 |
| 品號 PART NO. | 6STMS08-XXXXXXA01 | | | 繪圖 DRAWN | JOHN 2025/06/13 | |
| 圖號 DRAWING NO. | GN162-JH398 | 版本 REV. | D | 核對 CHECKED | JOSH 2025/06/13 | |
| 客戶品號 CUSTOMER P/N | | 比例 SCALE | None | 承認 APPROVED | JOSH 2025/06/13 | |
| 公差 TOLERANCE | 4<L≤16 ±0.3 L≤4 ±0.2 | 單位 UNIT | mm | THIRD ANGLE PROJECTION | | |