

NOTES:

*Material

Body : Nylon46,UL 94V-0 Rated.Color: Black
 Contacts : Brass

*Mechanical:

Insertion Force: 1.15N max per contact pair;
 Withdrawal Force: 0.15N min per contact pair;
 Contact Retention Force: 3.43N min per contact;

*Electrical Specification

Contact Resistance : 30 mΩ Max.
 Current Resistance : 1.1 Ampere
 Insulation Resistance : 1000 MΩ Min, At 500V AC.
 Operating Temperature : -55°C to +105°C

ORDER INFORMATION

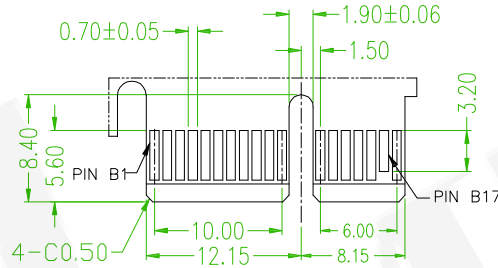
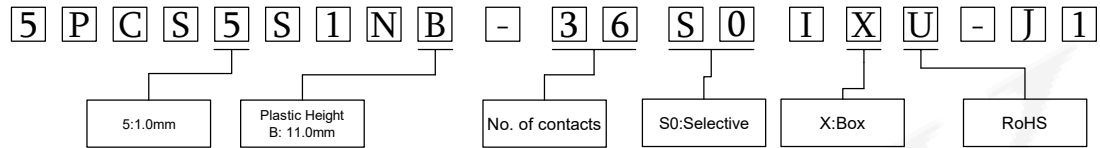

Primary (Component) Side

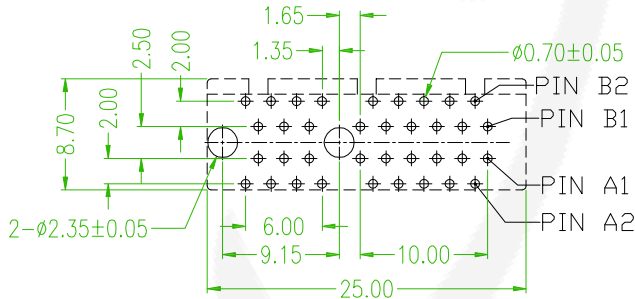
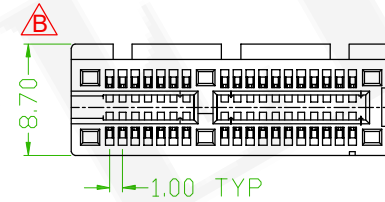
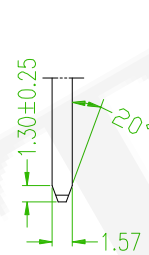

P.C.B LAYOUT
 COMPONENT SIDE

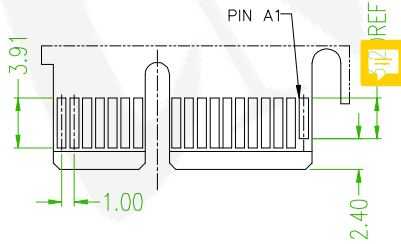

Secondary (Solder) Side

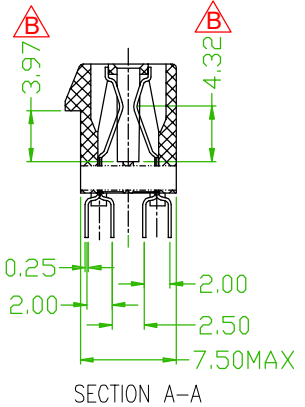
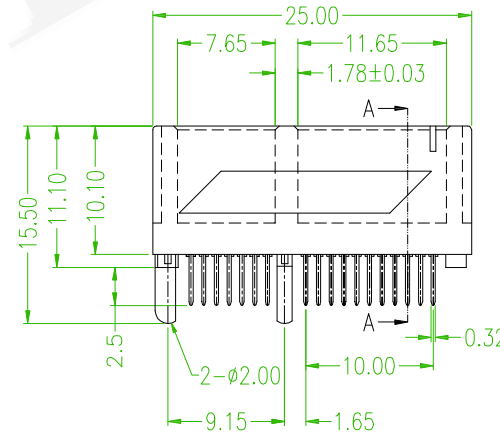

SECTION A-A

糧德精密有限公司
 Amtek Technology Co., Ltd.
 TEL: 886-2-2260-6878
 FAX: 886-2-2260-8030

品名 TITLE	PCI EXPRESS 36PIN (Chip Type)				頁數 Page	1/1
品號 PART NO.	5PCS5S1NB-36S0IXU-J1			繪圖 DRAWN	Nick 2019/08/20	
圖號 DRAWING NO.	GW032-NI309	版本 REV.	B	核對 CHECKED	Josh 2019/08/20	
客戶品號 CUSTOMER P/N		比例 SCALE	None	承認 APPROVED	Josh 2019/08/20	
公差 TOLERANCE	.X ± 0.35 .XX ± 0.25	X°±3°	單位 UNIT	mm	THIRD ANGLE PROJECTION	

	QEC NO.:210407 Revise the Drawing	Benson	2021/05/05
REV.	ECN NO. OR DESCRIPTION	REVISED	DATE