

# MATERIAL

Contact Pin: Brass

# ORDER INFORMATION

5 G B M - 0 3 7 X X - A X

◎:Standard Recommend

T0: Tin Plated  
◎ TM: Matte Tin

01=M2.5X0.45  
02=M3X0.5  
03=M4X0.7  
04=#6-32



THREAD
M2.5x0.45
M3x0.5
M4x0.7
#6-32

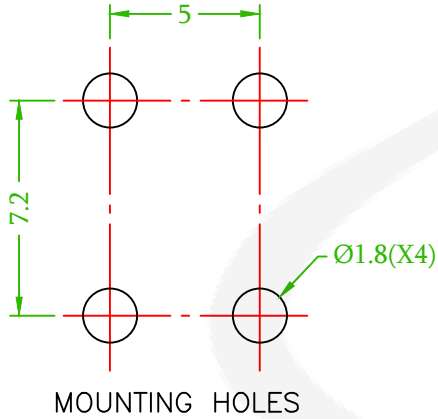
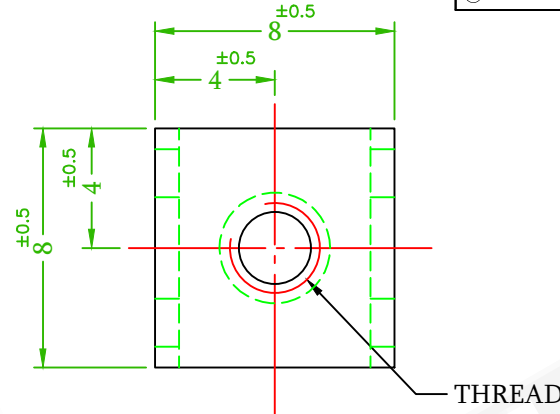

MOUNTING HOLES

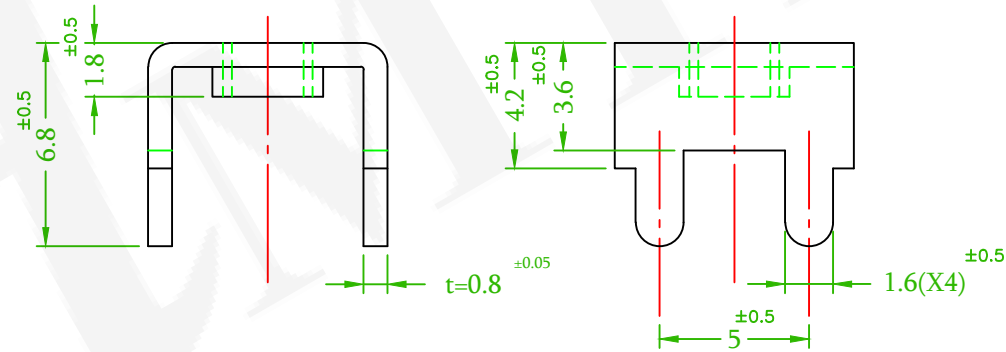

NOTE: 1. THE BEST USE TIME OF TIN PLATING PARTS ARE WITHIN 3 MONTHS SINCE MFG DATE.  
2. FINISH: TIN PLATED. IF PARTS ARE NOT USED UP PLEASE STORE IN A SEAL BAG.  
3. RECOMMEND CURRENT: 29A.

(RoHS Compliant)

Pb	<1000PPM
Cd	< 100PPM
Hg	<1000PPM
Cr6+	<1000PPM
PBBs	<1000PPM
PBDEs	<1000PPM

<p>糧德精密有限公司 Amtek Technology Co., Ltd. TEL: 886-2-2260-6878 FAX: 886-2-2260-8030</p>	品名 TITLE	P.C.B Terminal				頁數 Page	1/1
	品號 PART NO.	5GBM-037XX-AX				繪圖 DRAWN	Benson 2019/12/31
	圖號 DRAWING NO.	GW018-BS631	版本 REV.	B	核對 CHECKED	Josh 2019/12/31	
	客戶品號 CUSTOMER P/N		比例 SCALE	None	承認 APPROVED	Josh 2019/12/31	
	公差 TOLERANCE		單位 UNIT	mm	THIRD ANGLE PROJECTION		

QEC NO.:231104 Revise the Plating Options

Gaby 2023/12/07

REV.	ECN NO. OR DESCRIPTION	REVISED	DATE