

MATERIAL

Contact Pin:Brass

NOTE:

- 1.THE BEST USE TIME OF TIN PLATING PARTS ARE WITHIN 3 MONTHS SINCE MFG DATE.
- 2.FINISH: TIN PLATED. IF PARTS ARE NOT USED UP PLEASE STORE IN A SEAL BAG.
- 3.LOAD CURRENT:15A.

ORDER INFORMATION

5 G B M - 0 1 0 X X - A X

◎:Standard Recommend

T0:Tin Plated
◎TM:Matte Tin

See Table

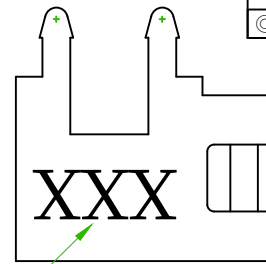

MARK

TAPPED

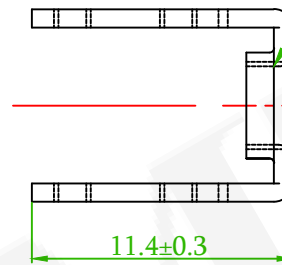

PART NO.	TAPPED	MARK
5GBM-010XX-A1	M3X0.5P	M3
5GBM-010XX-A2	M3.5X0.6P	M3.5
5GBM-010XX-A3	M4X0.7P	M4
5GBM-010XX-A4	6-32UNC	632

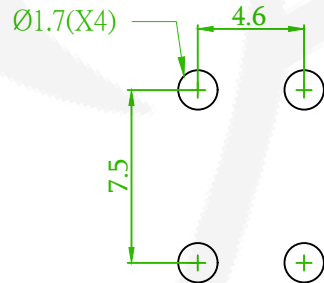

MOUMTING HOLES

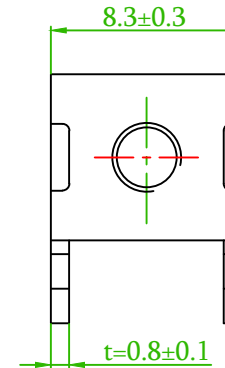
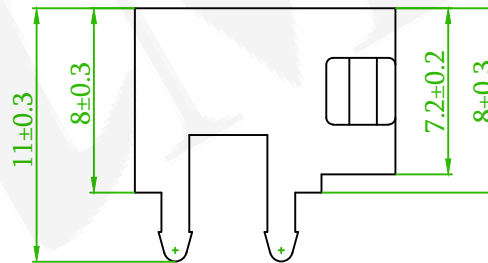

(RoHS Compliant)

★ Pb	<1000PPM
★ Cd	< 100PPM
★ Hg	<1000PPM
★ Cr6+	<1000PPM
★ PBBs	<1000PPM
★ PBDEs	<1000PPM

耀德精密有限公司
Amtek Technology Co., Ltd.
TEL: 886-2-2260-6878
FAX: 886-2-2260-8030

品名 TITLE	P.C.B TERMINAL				頁數 Page	1/1
品號 PART NO.	5GBM-010XX-AX			繪圖 DRAWN	Nick 2019/12/31	
圖號 DRAWING NO.	GW018-NI702	版本 REV.	B	核對 CHECKED	Josh 2019/12/31	
客戶品號 CUSTOMER P/N		比例 SCALE	None	承認 APPROVED	Josh 2019/12/31	
公差 TOLERANCE		單位 UNIT	mm	THIRD ANGLE PROJECTION		

QEC NO.:231104 Revise the Plating Options

Gaby 2023/11/27

REV. ECN NO. OR DESCRIPTION

REVISED DATE