

MATERIAL

Contact Pin:Brass

NOTE

- BEST USE DATE FOR TIN PLATED PARTS ARE WITHIN 3 MONTHS SINCE MFG DATE.
- TIN PLATED. IF PARTS ARE NOT USED UP PLEASE STORE IN A SEAL BAG.
- BEST USE DATE FOR NI PLATED PARTS ARE WITHIN 6 MONTHS SINCE MFG DATE.
- FINISH:NI PLATED. IF PARTS ARE NOT USED UP PLEASE STORE IN A SEAL BAG.

ORDER INFORMATION

5 G B M - 0 0 2 X X - A X

◎:Standard Recommend

T0:Tin Plated
◎TM:Matte Tin

See Table

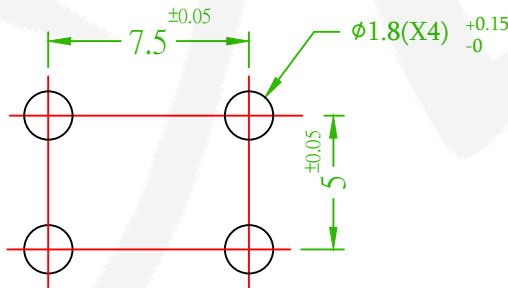
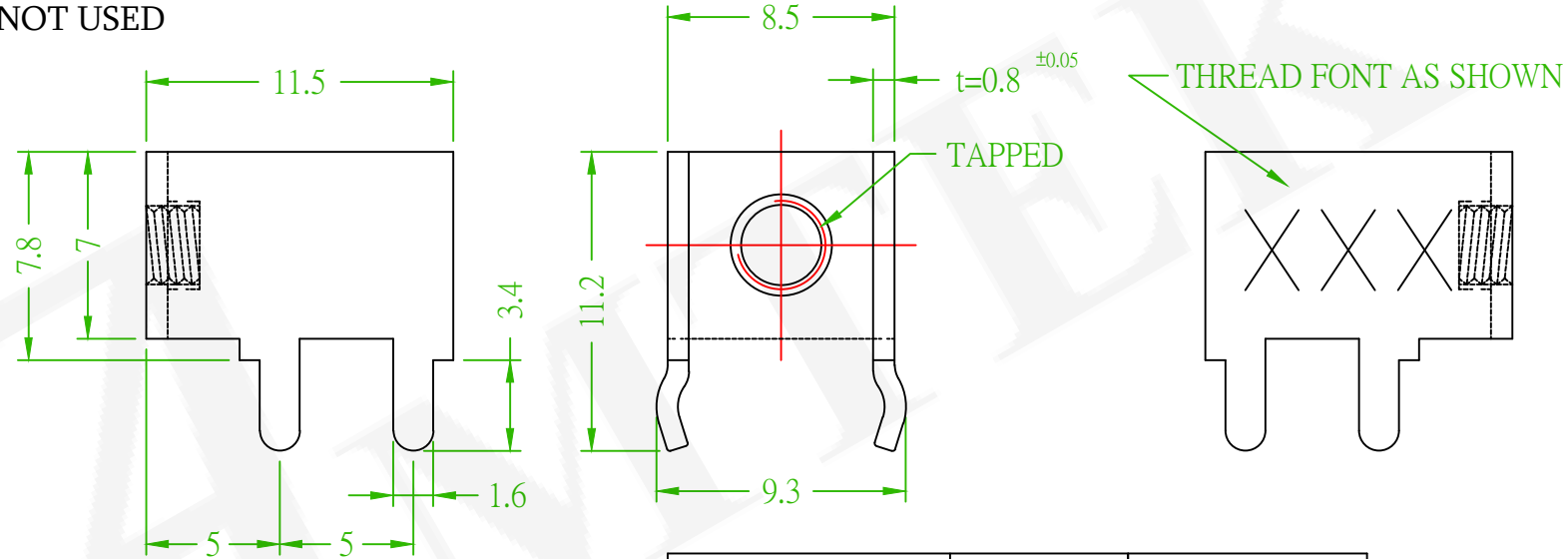

MOUNTING HOLES

PART NO.	TAPPED	THREAD FONT
5GBM-002XX-A1	M3	M3
5GBM-002XX-A2	M4	M4
5GBM-002XX-A2	M4	M4
5GBM-002XX-A3	UNC6-32	632
5GBM-002XX-A3	UNC6-32	632

(RoHS Compliant)	
★ Pb	<1000PPM
★ Cd	< 100PPM
★ Hg	<1000PPM
★ Cr6+	<1000PPM
★ PBBs	<1000PPM
★ PBDEs	<1000PPM

Amtek Technology Co., Ltd.
TEL: 886-2-2260-6878
FAX: 886-2-2260-8030

品名 TITLE	P.C.B TERMINAL				頁數 Page	1/1
品號 PART NO.	5GBM-002XX-AX			繪圖 DRAWN	Nick 2019/12/31	
圖號 DRAWING NO.	GW018-NI697	版本 REV.	B	核對 CHECKED	Josh 2019/12/31	
客戶品號 CUSTOMER P/N		比例 SCALE	None	承認 APPROVED	Josh 2019/12/31	
公差 TOLERANCE	±0.2	單位 UNIT	mm	THIRD ANGLE PROJECTION		

REV.	ECN NO. OR DESCRIPTION	REVISED	DATE
	QEC NO.:231104 Revise the Plating Options	Gaby	2023/11/24