

**MATERIAL**

Contact Pin:Brass

**ORDER INFORMATION**

5 G B L - 0 0 6 X X - A 1

◎:Standard Recommend

T0: Tin Plated  
◎TM: Matte Tin



AMTEK 耀德  
2023.12.20  
Released DCC

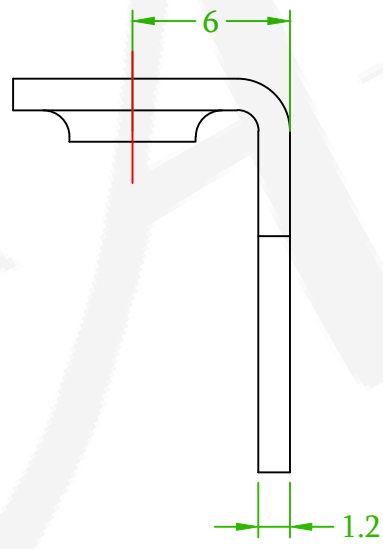
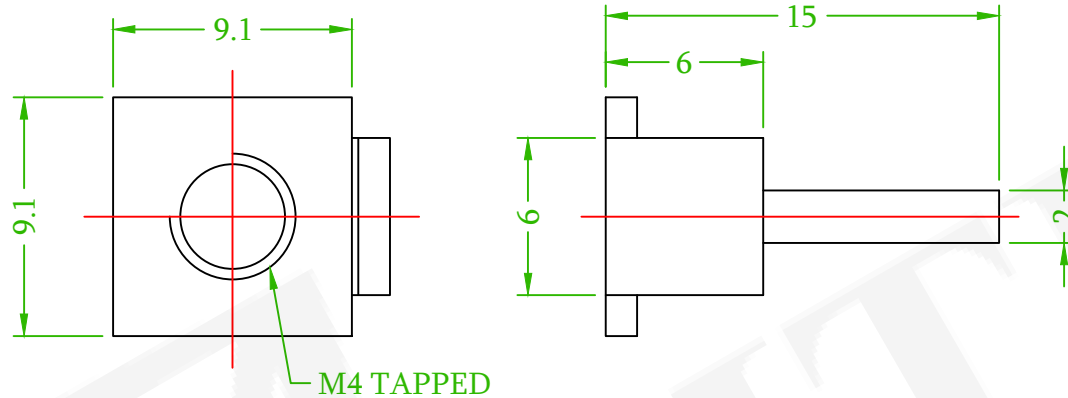

M4 TAPPED

HOLE IN P.C.B:  $\phi 2.5 \pm 0.05$

DIM	TOL
5mm DOWN	$\pm 0.2$
5~20mm	$\pm 0.3$
20~40mm	$\pm 0.4$
40~60mm	$\pm 0.5$
60~100mm	$\pm 0.8$
100mm UP	$\pm 1.0$

(RoHS Compliant)

★ Pb	<1000PPM
★ Cd	< 100PPM
★ Hg	<1000PPM
★ Cr6+	<1000PPM
★ PBBs	<1000PPM
★ PBDEs	<1000PPM

耀德精密有限公司  
Amtek Technology Co., Ltd.  
TEL: 886-2-2260-6878  
FAX: 886-2-2260-8030

品名 TITLE	P.C.B Terminal				頁數 Page	1/1
品號 PART NO.	5GBL-006XX-A1			繪圖 DRAWN	Nick 2019/12/31	
圖號 DRAWING NO.	GW018-NI675	版本 REV.	B	核對 CHECKED	Josh 2019/12/31	
客戶品號 CUSTOMER P/N		比例 SCALE	None	承認 APPROVED	Josh 2019/12/31	
公差 TOLERANCE		單位 UNIT	mm	THIRD ANGLE PROJECTION		

REV.	ECN NO. OR DESCRIPTION	REVISED	DATE
◎	QEC NO.:231104 Revise the Plating Options	Gaby	2023/11/23