

SPECIFICATION

Current Rating: 3 AMP
 Insulation Resistance: 1000MΩ Min.
 Contact Resistance: 25mΩ Max.
 Dielectric Voltage: 500VAC for one minute
 Operation Temperature: -55 °C to +85 °C

MATERIAL

Insulator: PBT, UL94V-0
 Contact Pin: Copper Alloy

ORDER INFORMATION

5 7 S D D R X F - X X A X X X B A - 0 X

1: Tin shell + L(RoHS)
 2: Nickel shell + L(RoHS)

F: Female

No. of Contacts (09.25)

A: With Forking Grounding

A: Thread Insert #4-40
 B: Thread Insert #4-40 + Jack Screw #4-40 Attached
 C: Thread Insert #4-40 + Jack Screw #4-40 Removable

S0: Selective Au
 SF: Selective 15u"
 SD: Selective 30u"

B: Black

A: Tray

Screw Height
 1: 4.8mm
 4: 5.8mm



AMTEK 糧德
 2023.09.25
 Released DCC

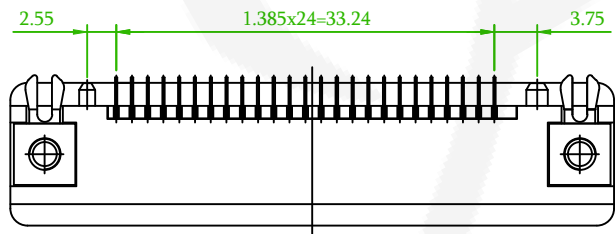
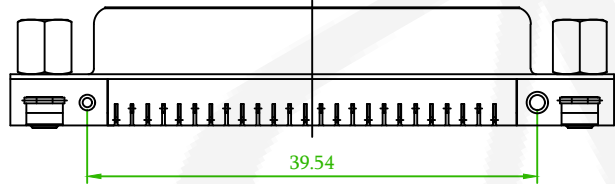
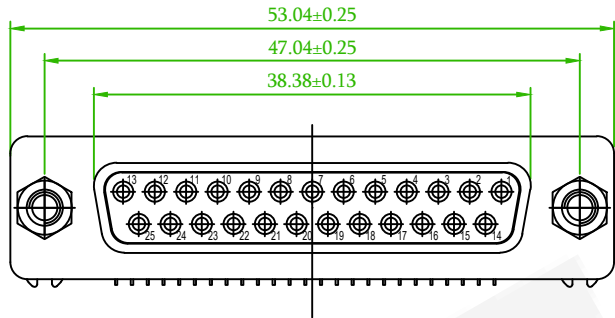

25 Pin

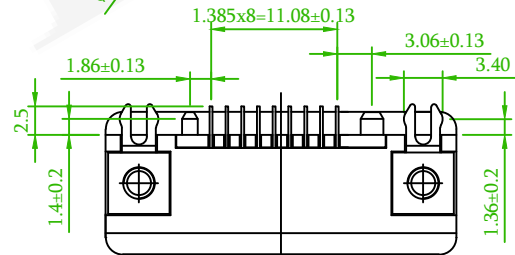
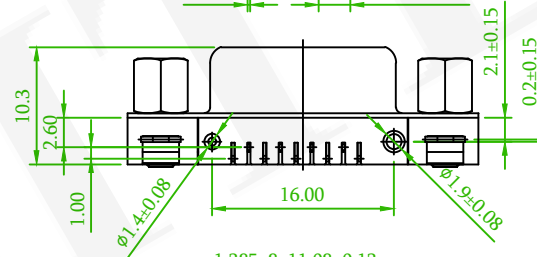
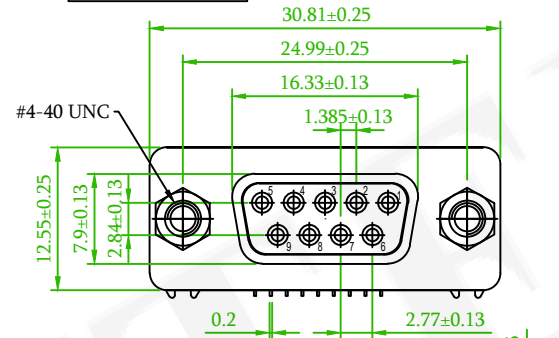

09 Pin

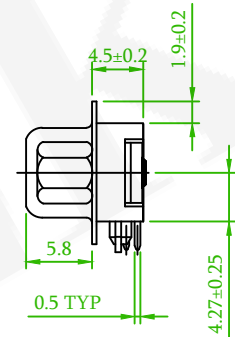

Old Part No.: MNDBR-FXX-L

△	EasyFlow:202309220001 Add the Screw Height	Alice	2023/09/25
△	Add the 25 Pin	Roy	2018/09/11
△	Delete the Option: 8:Rivet & Jack Screw Insert(5.8x11.8mm)	Roy	2017/04/11
REV.	ECN NO. OR DESCRIPTION	REVISED	DATE

糧德精密有限公司
 Amtek Technology Co., Ltd.
 TEL: 886-2-2268-8036
 FAX: 886-2-2268-8035

品名 TITLE	D-SUB SLIM RIGHT ANGLE TYPE				頁數 Page	1/2
品號 PART NO.	△△57SDDRFX-XXAXXXBA-0X			繪圖 DRAWN	Roy 2016/11/15	
圖號 DRAWING NO.	GW037-RL070		版本 REV.	E	核對 CHECKED	Josh 2018/09/11
客戶品號 CUSTOMER P/N			比例 SCALE	None	承認 APPROVED	Jason 2018/09/11
公差 TOLERANCE	.X ±0.25	.XX ±0.15	單位 UNIT	mm	THIRD ANGLE PROJECTION	



AMTEK 耀德
2023.09.25
Released DCC

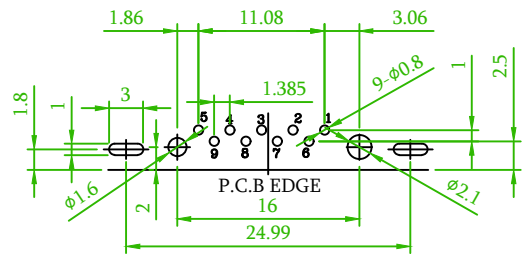

09 Pin

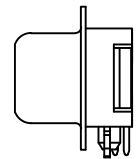

Thread Insert #4-40

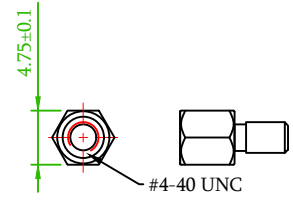

Thread Insert #4-40
+ Jack Screw #4-40 Attached

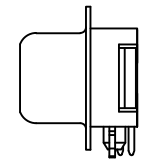

Thread Insert #4-40
+ Jack Screw #4-40 Removable

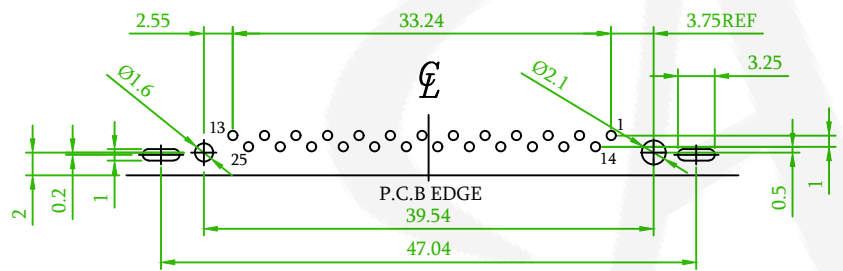
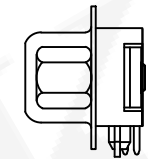

25 Pin

Recommended PCB Layout
(PCB TOLERANCE ±0.05)

P/N	Screw Height
57SDDRXF-XXABXXBA-01 57SDDRXF-XXACXXBA-01	4.8
57SDDRXF-XXABXXBA-04 57SDDRXF-XXACXXBA-04	5.8

△	EasyFlow:202309220001 Add the Screw Height	Alice	2023/09/25
△	Add the 25 Pin	Roy	2018/09/11
△	Delete the Option: 8:Rivet & Jack Screw Insert(5.8x11.8mm)	Roy	2017/04/11
REV.	ECN NO. OR DESCRIPTION	REVISED	DATE

耀德精密有限公司
Amtek Technology Co., Ltd.
TEL: 886-2-2268-8036
FAX: 886-2-2268-8035

品名 TITLE	D-SUB SLIM RIGHT ANGLE TYPE				頁數 Page	2/2
品號 PART NO.	△△57SDDRXF-XXAXXXBA-0X		繪圖 DRAWN	Roy		2016/11/15
圖號 DRAWING NO.	GW037-RL070	版本 REV.	E	核對 CHECKED	Josh 2018/09/11	
客戶品號 CUSTOMER P/N		比例 SCALE	None	承認 APPROVED	Jason 2018/09/11	
公差 TOLERANCE	.X ±0.25 .XX ±0.15	單位 UNIT	mm	THIRD ANGLE PROJECTION		