

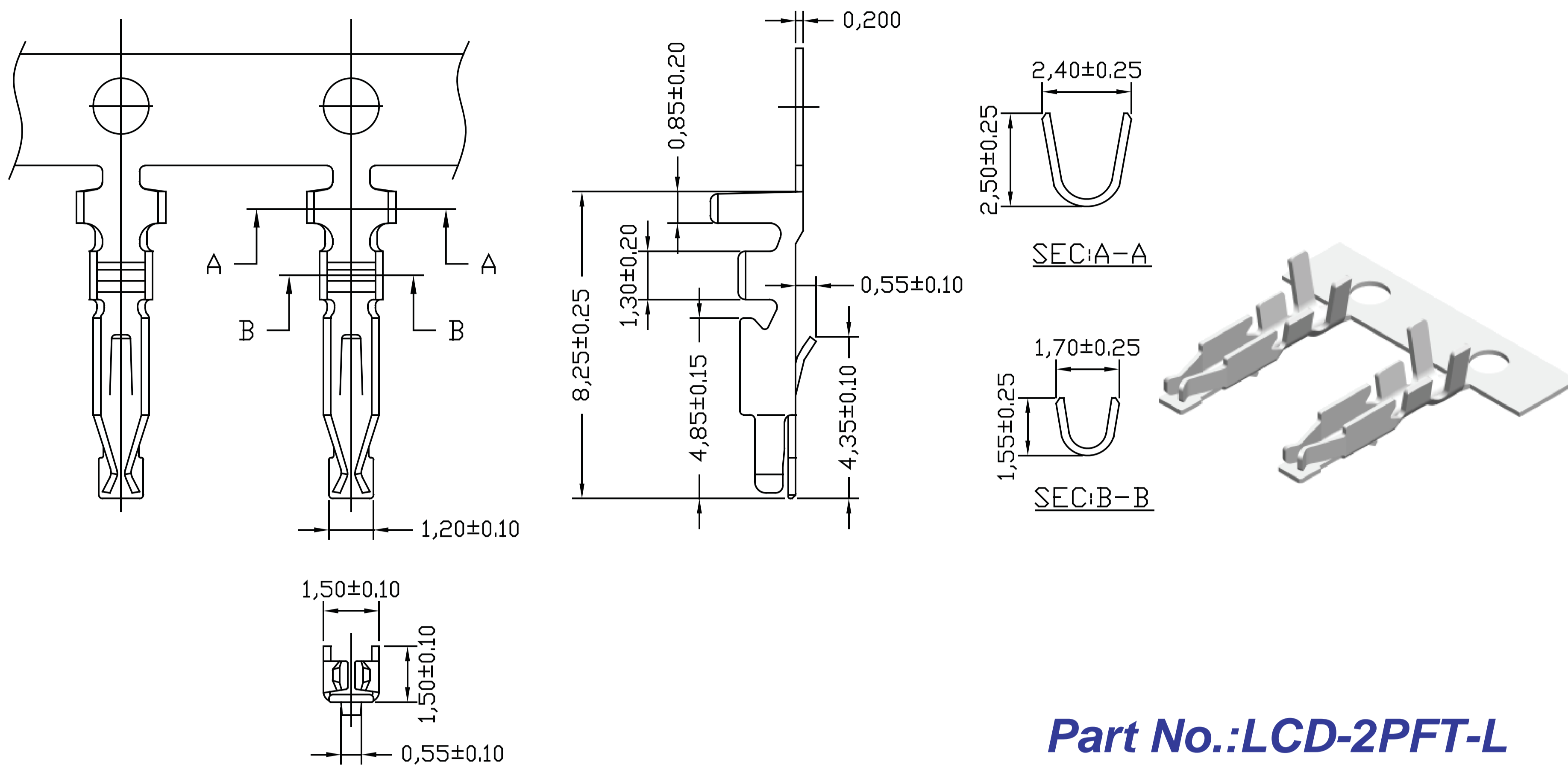

## 3.5mm LCD Terminal / Housing



Wire Range	Insulation O.D.	Material	Finish	Qty/reel
AWG#24-#28	1.60mm(max)	Phosphor Bronze	Tin-plated	10,000pcs
AWG#24-#28	1.60mm(max)	Phosphor Bronze	Tin-plated	10,000pcs

### SPECIFICATIONS

Current Rating: 1A AC,DC  
 Voltage Rating: 1400V AC,DC  
 Temperature Range: -25°C ~ +85°C  
 Contact Resistance: 10mΩ Max  
 Insulation Resistance: 1000MΩ Min  
 Withstanding Voltage: 3800V AC/minute  
 Material: Nylon 66,UL94V-0  
 Color: Natural(White)

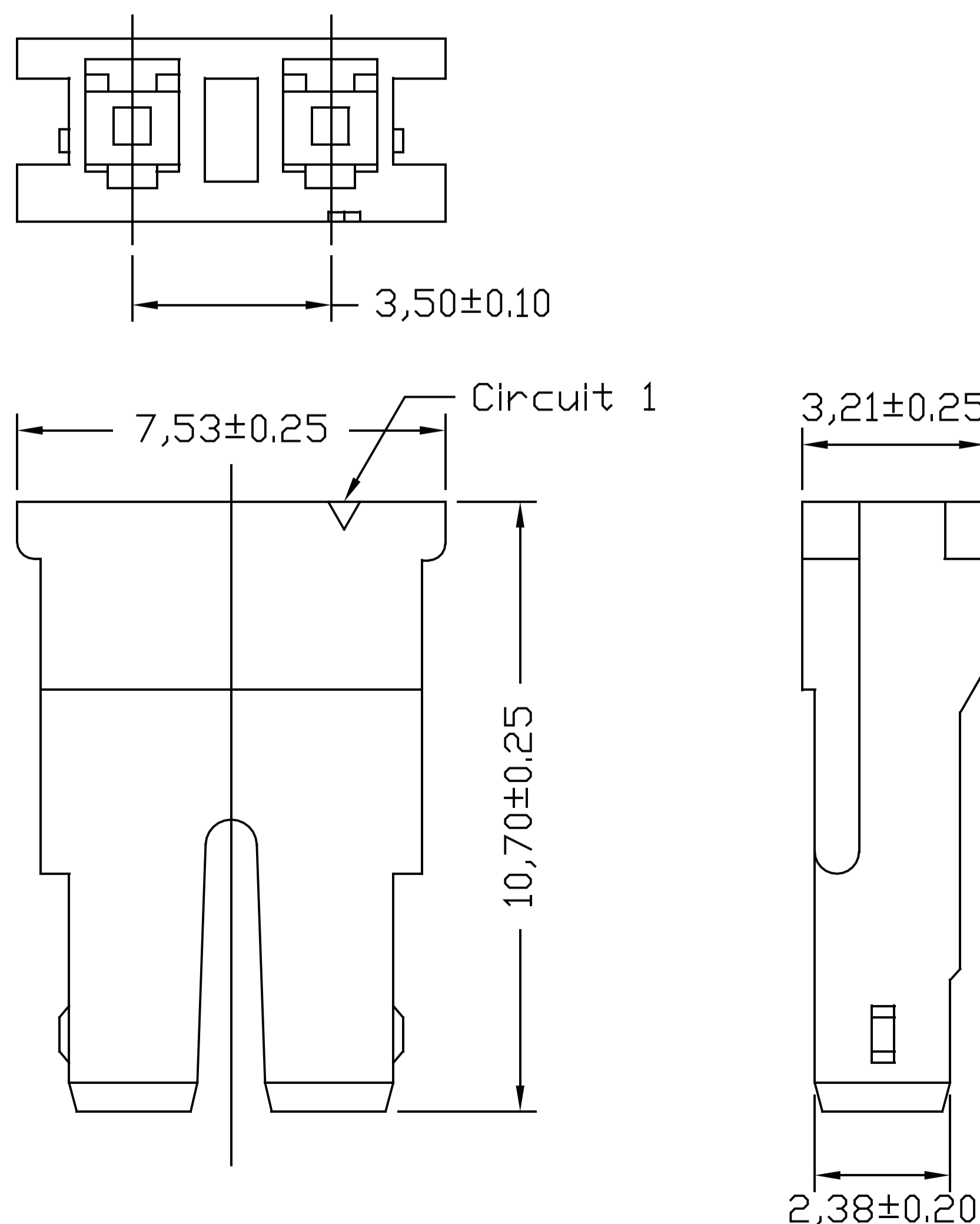
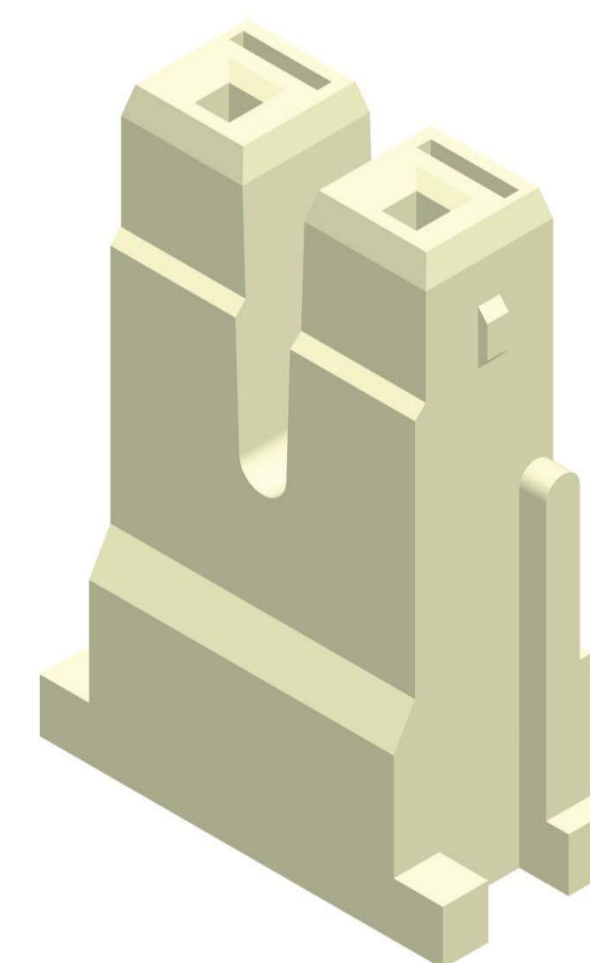

**H**ousing wafer Terminal



**RoHS**

AMTEK CONNECTORS MANUFACTURER